

STAINLESS STEEL BUTT-WELDING FITTINGS

90° ELBOW (LONG)

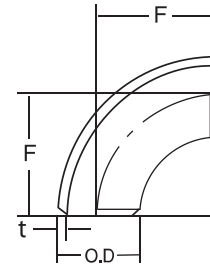

KS B1541 / B1543
JIS B2312 / B2313

UNIT : mm

UNIT : KG

NOMINAL PIPE SIZE	OUTSIDE DIAMETER (O.D)	WALL THICKNESS(t)				CENTER TO END	WEIGHT			
		SCH 5s	SCH 10s	SCH 20s	SCH 40	F	SCH 5s	SCH 10s	SCH 20s	SCH 40
15	21.7	1.65	2.1	2.5	2.8	38.1	0.05	0.06	0.07	0.08
20	27.2	1.65	2.1	2.5	2.9	38.1	0.06	0.08	0.09	0.10
25	34.0	1.65	2.8	3.0	3.4	38.1	0.08	0.13	0.14	0.15
32	42.7	1.65	2.8	3.0	3.6	47.6	0.12	0.21	0.22	0.26
40	48.6	1.65	2.8	3.0	3.7	57.2	0.17	0.28	0.30	0.37
50	60.5	1.65	2.8	3.5	3.9	76.2	0.29	0.48	0.59	0.65
65	76.3	2.10	3.0	3.5	5.2	95.3	0.57	0.81	0.94	1.36
80	89.1	2.10	3.0	4.0	5.5	114.3	0.81	1.14	1.51	2.03
90	101.6	2.10	3.0	4.0	5.7	133.4	1.08	1.53	2.02	2.82
100	114.3	2.10	3.0	4.0	6.0	152.4	1.39	1.97	2.60	3.83
125	139.8	2.80	3.4	5.0	6.6	190.5	2.83	3.42	4.97	6.48
150	165.2	2.80	3.4	5.0	7.1	228.6	4.02	4.87	7.09	9.93
200	216.3	2.80	4.0	6.5	8.2	304.8	7.05	10.02	16.09	20.14
250	267.4	3.40	4.0	6.5	9.3	381.0	13.20	15.50	25.00	35.40
300	318.5	4.00	4.5	6.5	10.3	457.2	22.30	25.00	35.90	56.20
350	355.6	4.00	4.8	7.9	11.1	533.4	29.00	34.80	56.70	79.00
400	406.4	4.20	4.8	7.9	12.7	609.6	39.90	45.50	74.30	118.00
450	457.2	4.20	4.8	7.9	14.3	685.8	50.50	57.70	94.20	169.00
500	508.0	4.80	5.5	9.5	15.1	762.0	71.30	81.50	139.70	219.60
550	558.8	4.80	5.5	9.5	15.1	838.2	86.30	98.80	169.30	266.40
600	609.6	5.50	6.4	9.5	17.4	914.4	117.60	136.70	201.80	364.80
650	660.4	5.5	7.9	12.7	17.4	990.6	138.10	197.70	315.50	429.10
700	711.2	5.5	7.9	12.7	17.4	1,066.8	160.30	229.50	366.40	498.60
750	762.0	6.4	7.9	12.7	17.4	1,143.0	214.00	263.60	421.10	573.30
800	812.8	6.4	7.9	12.7	17.4	1,219.2	243.60	300.10	479.60	653.30
850	863.8	6.4	7.9	12.7	17.4	1,295.4	275.10	339.00	542.00	738.40
900	914.4	6.4	7.9	12.7	19.0	1,371.6	308.60	380.30	608.10	903.40
950	965.2	6.4	7.9	12.7	19.0	1,447.8	344.00	423.90	678.10	1,007.70
1,000	1,016.0	6.4	9.5	14.3	26.2	1,524.0	381.20	564.20	845.20	1,530.10
1,050	1,066.8	6.4	9.5	14.3	26.2	1,600.2	420.50	622.30	932.40	1,689.10
1,100	1,117.6	6.4	9.5	14.3	26.2	1,676.4	461.60	683.20	1,024.00	-
1,150	1,168.4	6.4	9.5	14.3	26.2	1,752.6	504.60	747.00	1,119.80	-
1,200	1,219.2	6.4	9.5	14.3	26.2	1,828.8	549.60	813.70	1,220.00	-
1,250	1,270.0	6.4	9.5	14.3	26.2	1,905.0	596.50	883.20	1,324.40	-
1,300	1,320.8	6.4	9.5	14.3	26.2	1,981.2	645.20	955.50	1,433.10	-
1,350	1,371.6	6.4	9.5	14.3	26.2	2,057.4	696.00	1,030.70	1,546.00	-
1,400	1,422.4	6.4	9.5	14.3	26.2	2,133.6	748.60	1,108.80	1,663.30	-
1,450	1,473.2	6.4	9.5	14.3	26.2	2,209.8	803.10	1,189.60	1,784.90	-
1,500	1,524.0	6.4	9.5	14.3	26.2	2,286.0	859.60	1,273.40	1,910.70	-

FOR DIMENSIONAL TOLERANCES AND BEVEL DETAILS, SEE PAGE 49, 53.

STAINLESS STEEL BUTT-WELDING FITTINGS

90° ELBOW (SHORT)

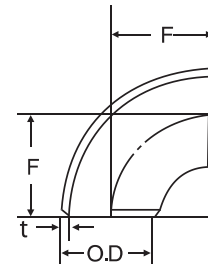

KS B1541 / B1543
JIS B2312 / B2313

UNIT : mm

UNIT : KG

NOMINAL PIPE SIZE	OUTSIDE DIAMETER (O.D)	WALL THICKNESS(t)				CENTER TO END	WEIGHT			
		SCH 5s	SCH 10s	SCH 20s	SCH 40	F	SCH 5s	SCH 10s	SCH 20s	SCH 40
25	34.0	1.65	2.8	3.0	3.4	25.4	0.05	0.09	0.09	0.10
32	42.7	1.65	2.8	3.0	3.6	31.8	0.08	0.14	0.15	0.17
40	48.6	1.65	2.8	3.0	3.7	38.1	0.11	0.19	0.20	0.25
50	60.5	1.65	2.8	3.5	3.9	50.8	0.19	0.32	0.39	0.43
65	76.3	2.10	3.0	3.5	5.2	63.5	0.38	0.54	0.63	0.91
80	89.1	2.10	3.0	4.0	5.5	76.2	0.54	0.76	1.00	1.36
90	101.6	2.10	3.0	4.0	5.7	88.9	0.72	1.02	1.34	1.88
100	114.3	2.10	3.0	4.0	6.0	101.6	0.93	1.31	1.74	2.56
125	139.8	2.80	3.4	5.0	6.6	127.0	1.89	2.28	3.31	4.32
150	165.2	2.80	3.4	5.0	7.1	152.4	2.68	3.25	4.73	6.62
200	216.3	2.80	4.0	6.5	8.2	203.2	4.70	6.68	10.73	13.42
250	267.4	3.40	4.0	6.5	9.3	254.0	8.80	10.40	16.70	23.60
300	318.5	4.00	4.5	6.5	10.3	304.8	14.80	16.70	23.90	37.50
350	355.6	4.00	4.8	7.9	11.1	355.6	19.40	23.20	37.80	52.60
400	406.4	4.20	4.8	7.9	12.7	406.4	26.60	30.30	49.50	78.70
450	457.2	4.20	4.8	7.9	14.3	457.2	33.70	38.40	62.80	112.10
500	508.0	4.80	5.5	9.5	15.1	508.0	47.50	54.40	93.10	146.40
550	558.8	4.80	5.5	9.5	15.1	558.8	57.50	65.80	112.90	177.60
600	609.6	5.50	6.4	9.5	17.4	609.6	78.40	91.10	134.50	243.20
650	660.4	5.5	7.9	12.7	17.4	660.4	92.10	131.80	210.30	286.10
700	711.2	5.5	7.9	12.7	17.4	711.2	106.90	153.00	244.30	332.40
750	762.0	6.4	7.9	12.7	17.4	762.0	142.70	175.80	280.70	382.20
800	812.8	6.4	7.9	12.7	17.4	812.8	162.40	200.10	319.80	435.50
850	863.8	6.4	7.9	12.7	17.4	863.8	183.50	226.10	361.40	492.40
900	914.4	6.4	7.9	12.7	19.0	914.4	205.70	253.50	405.40	602.30
950	965.2	6.4	7.9	12.7	19.0	965.2	229.30	282.60	452.00	671.80
1,000	1,016.0	6.4	9.5	14.3	26.2	1,016.0	254.20	376.10	563.50	1,020.10
1,050	1,066.8	6.4	9.5	14.3	26.2	1,066.8	280.30	414.90	621.60	1,126.10
1,100	1,117.6	6.4	9.5	14.3	26.2	1,117.6	307.70	455.50	682.70	-
1,150	1,168.4	6.4	9.5	14.3	26.2	1,168.4	336.40	498.00	746.60	-
1,200	1,219.2	6.4	9.5	14.3	26.2	1,219.2	366.40	542.50	813.30	-
1,250	1,270.0	6.4	9.5	14.3	26.2	1,270.0	397.60	588.80	882.90	-
1,300	1,320.8	6.4	9.5	14.3	26.2	1,320.8	430.20	637.00	955.40	-
1,350	1,371.6	6.4	9.5	14.3	26.2	1,371.6	464.00	687.10	1,030.70	-
1,400	1,422.4	6.4	9.5	14.3	26.2	1,422.4	499.10	739.20	1,108.90	-
1,450	1,473.2	6.4	9.5	14.3	26.2	1,473.2	535.40	793.10	1,189.90	-
1,500	1,524.0	6.4	9.5	14.3	26.2	1,524.0	573.10	848.90	1,273.80	-

FOR DIMENSIONAL TOLERANCES AND BEVEL DETAILS, SEE PAGE 49, 53.

STAINLESS STEEL BUTT-WELDING FITTINGS

45° ELBOW (LONG)

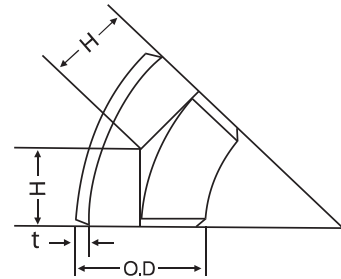

KS B1541 / B1543
JIS B2312 / B2313

UNIT : mm

UNIT : KG

NOMINAL PIPE SIZE	OUTSIDE DIAMETER (O.D)	WALL THICKNESS(t)				CENTER TO END H	WEIGHT			
		SCH 5s	SCH 10s	SCH 20s	SCH 40		SCH 5s	SCH 10s	SCH 20s	SCH 40
15	21.7	1.65	2.1	2.5	2.8	15.8	0.02	0.03	0.04	0.04
20	27.2	1.65	2.1	2.5	2.9	15.8	0.03	0.04	0.05	0.06
25	34.0	1.65	2.8	3.0	3.4	15.8	0.04	0.06	0.07	0.08
32	42.7	1.65	2.8	3.0	3.6	19.7	0.06	0.10	0.11	0.13
40	48.6	1.65	2.8	3.0	3.7	23.7	0.09	0.14	0.15	0.18
50	60.5	1.65	2.8	3.5	3.9	31.6	0.14	0.24	0.30	0.33
65	76.3	2.10	3.0	3.5	5.2	39.5	0.29	0.41	0.47	0.68
80	89.1	2.10	3.0	4.0	5.5	47.3	0.41	0.57	0.75	1.02
90	101.6	2.10	3.0	4.0	5.7	55.3	0.54	0.76	1.01	1.41
100	114.3	2.10	3.0	4.0	6.0	63.1	0.70	0.96	1.30	1.92
125	139.8	2.80	3.4	5.0	6.6	78.9	1.42	1.71	2.49	3.24
150	165.2	2.80	3.4	5.0	7.1	94.7	2.01	2.43	3.54	4.97
200	216.3	2.80	4.0	6.5	8.2	126.3	3.53	5.01	8.05	10.10
250	267.4	3.40	4.0	6.5	9.3	157.8	6.62	7.77	12.50	17.70
300	318.5	4.00	4.5	6.5	10.3	189.4	11.10	12.50	17.90	28.10
350	355.6	4.00	4.8	7.9	11.1	220.9	14.40	17.30	28.50	40.00
400	406.4	4.20	4.8	7.9	12.7	252.5	19.90	22.70	37.30	59.00
450	457.2	4.20	4.8	7.9	14.3	284.1	25.20	28.70	47.30	84.50
500	508.0	4.80	5.5	9.5	15.1	315.6	35.50	41.10	70.00	105.00
550	558.8	4.80	5.5	9.5	15.1	347.2	43.00	49.80	85.00	133.50
600	609.6	5.50	6.4	9.5	17.4	378.7	59.00	68.00	101.00	183.00
650	660.4	5.5	7.9	12.7	17.4	410.3	70	99	158	215
700	711.2	5.5	7.9	12.7	17.4	441.9	81	115	183	250
750	762.0	6.4	7.9	12.7	17.4	473.4	106	132	210	288
800	812.8	6.4	7.9	12.7	17.4	505.0	121	150	240	328
850	863.8	6.4	7.9	12.7	17.4	536.6	136	170	271	371
900	914.4	6.4	7.9	12.7	19.0	568.1	153	191	304	453
950	965.2	6.4	7.9	12.7	19.0	599.7	171	212	339	505
1,000	1,016.0	6.4	9.5	14.3	26.2	631.2	189	235	376	560
1,050	1,066.8	6.4	9.5	14.3	26.2	662.8	207	259	311	452
1,100	1,117.6	6.4	9.5	14.3	26.2	694.4	225	285	342	-
1,150	1,168.4	6.4	9.5	14.3	26.2	725.9	244	312	374	-
1,200	1,219.2	6.4	9.5	14.3	26.2	757.5	272	339	407	-
1,250	1,270.0	6.4	9.5	14.3	26.2	788.9	291	336	435	-
1,300	1,320.8	6.4	9.5	14.3	26.2	820.4	311	393	462	-
1,350	1,371.6	6.4	9.5	14.3	26.2	852.2	336	420	489	-
1,400	1,422.4	6.4	9.5	14.3	26.2	883.6	358	457	516	-
1,450	1,473.2	6.4	9.5	14.3	26.2	915.4	384	484	541	-
1,500	1,524.0	6.4	9.5	14.3	26.2	946.9	401	501	569	-

FOR DIMENSIONAL TOLERANCES AND BEVEL DETAILS, SEE PAGE 49, 53.

STAINLESS STEEL BUTT-WELDING FITTINGS

TEE (STRAIGHT & REDUCING)

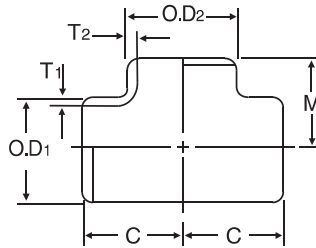

UNIT : mm

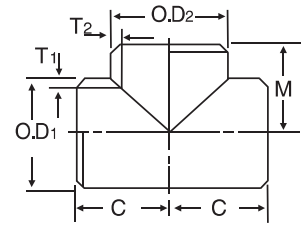

UNIT : KG

KS B1541 / B1543
JIS B2312 / B2313

NOMINAL PIPE SIZE	OUTSIDE DIAMETER		WALL THICKNESS(t)						CENTER TO END		WEIGHT		
			SCH 10s		SCH 20s		SCH 40		C	M	SCH 10s	SCH 20s	SCH 40
			T ₁	T ₂	T ₁	T ₂	T ₁	T ₂					
15 × 15	21.7	21.7	2.1	2.1	2.5	2.5	2.8	2.8	25.4	25.4	0.07	0.08	0.09
20 × 20	27.2	27.2	2.1	2.1	2.5	2.5	2.9	2.9	28.6	28.6	0.09	0.11	0.13
20 × 15	27.2	21.7	2.1	2.1	2.5	2.5	2.9	2.8	28.6	28.6	0.07	0.10	0.12
25 × 25	34.0	34.0	2.8	2.8	3.0	3.0	3.4	3.4	38.1	38.1	0.21	0.22	0.25
25 × 20	34.0	27.2	2.8	2.1	3.0	2.5	3.4	2.9	38.1	38.1	0.19	0.21	0.23
25 × 15	34.0	21.7	2.8	2.1	3.0	2.5	3.4	2.8	38.1	38.1	0.18	0.20	0.22
32 × 32	42.7	42.7	2.8	2.8	3.0	3.0	3.6	3.6	47.6	47.6	0.34	0.36	0.42
32 × 25	42.7	34.0	2.8	2.8	3.0	3.0	3.6	3.4	47.6	47.6	0.32	0.34	0.40
32 × 20	42.7	27.2	2.8	2.1	3.0	2.5	3.6	2.9	47.6	47.6	0.30	0.32	0.38
32 × 15	42.7	21.7	2.8	2.1	3.0	2.5	3.6	2.8	47.6	47.6	0.29	0.31	0.36
40 × 40	48.6	48.6	2.8	2.8	3.0	3.0	3.7	3.7	57.2	57.2	0.47	0.50	0.60
40 × 32	48.6	42.7	2.8	2.8	3.0	3.0	3.7	3.6	57.2	57.2	0.45	0.48	0.58
40 × 25	48.6	34.0	2.8	2.8	3.0	3.0	3.7	3.4	57.2	57.2	0.43	0.46	0.55
40 × 20	48.6	27.2	2.8	2.1	3.0	2.5	3.7	2.9	57.2	57.2	0.40	0.44	0.53
40 × 15	48.6	21.7	2.8	2.1	3.0	2.5	3.7	2.8	57.2	57.2	0.39	0.42	0.51
50 × 50	60.5	60.5	2.8	2.8	3.5	3.5	3.9	3.9	63.5	63.5	0.64	0.79	0.87
50 × 40	60.5	48.6	2.8	2.8	3.5	3.0	3.9	3.7	63.5	60.3	0.60	0.73	0.81
50 × 32	60.5	42.7	2.8	2.8	3.5	3.0	3.9	3.6	63.5	57.2	0.58	0.70	0.79
50 × 25	60.5	34.0	2.8	2.8	3.5	3.0	3.9	3.4	63.5	50.8	0.55	0.67	0.74
50 × 20	60.5	27.2	2.8	2.1	3.5	2.5	3.9	2.9	63.5	44.5	0.45	0.59	0.68
65 × 65	76.3	76.3	3.0	3.0	3.5	3.5	5.2	5.2	76.2	76.2	1.03	1.20	1.74
65 × 50	76.3	60.5	3.0	2.8	3.5	3.5	5.2	3.9	76.2	69.9	0.95	1.11	1.56
65 × 40	76.3	48.6	3.0	2.8	3.5	3.0	5.2	3.7	76.2	66.7	0.92	1.05	1.51
65 × 32	76.3	42.7	3.0	2.8	3.5	3.0	5.2	3.6	76.2	63.5	0.90	1.03	1.48
65 × 25	76.3	34.0	3.0	2.8	3.5	3.0	5.2	3.4	76.2	57.2	0.87	1.00	1.44
80 × 80	89.1	89.1	3.0	3.0	4.0	4.0	5.5	5.5	85.7	85.7	1.35	1.78	2.41
80 × 65	89.1	76.3	3.0	3.0	4.0	3.5	5.5	5.2	85.7	82.6	1.30	1.68	2.29
80 × 50	89.1	60.5	3.0	2.8	4.0	3.5	5.5	3.9	85.7	76.2	1.22	1.59	2.12
80 × 40	89.1	48.6	3.0	2.8	4.0	3.0	5.5	3.7	85.7	73.0	1.18	1.53	2.06
80 × 32	89.1	42.7	3.0	2.8	4.0	3.0	5.5	3.6	85.7	69.9	1.16	1.51	2.03
100 × 100	114.3	114.3	3.0	3.0	4.0	4.0	6.0	6.0	104.8	104.8	2.12	2.80	4.12
100 × 80	114.3	89.1	3.0	3.0	4.0	4.0	6.0	5.5	104.8	98.4	1.99	2.68	3.83
100 × 65	114.3	76.3	3.0	3.0	4.0	3.5	6.0	5.2	104.8	95.3	1.93	2.52	3.71
100 × 50	114.3	60.5	3.0	2.8	4.0	3.5	6.0	3.9	104.8	88.9	1.85	2.44	3.53
100 × 40	114.3	48.6	3.0	2.8	4.0	3.0	6.0	3.7	104.8	85.7	1.82	2.38	3.47
125 × 125	139.8	139.8	3.4	3.4	5.0	5.0	6.6	6.6	123.8	123.8	3.45	5.01	6.54
125 × 100	139.8	114.3	3.4	3.0	5.0	4.0	6.6	6.0	123.8	117.5	3.22	4.63	6.13
125 × 80	139.8	89.1	3.4	3.0	5.0	4.0	6.6	5.5	123.8	111.1	3.09	4.49	5.83
125 × 65	139.8	76.3	3.4	3.2	5.0	3.5	6.6	5.2	123.8	108.0	3.04	4.35	5.71
125 × 50	139.8	60.5	3.4	2.8	5.0	3.5	6.6	3.9	123.8	104.8	2.97	4.29	5.56

FOR DIMENSIONAL TOLERANCES AND BEVEL DETAILS, SEE PAGE 49, 53.

STAINLESS STEEL BUTT-WELDING FITTINGS

TEE

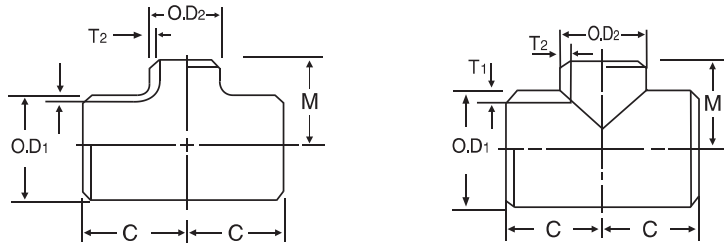

KS B1541 / B1543
JIS B2312 / B2313

UNIT : mm

UNIT : KG

NOMINAL PIPE SIZE	OUTSIDE DIAMETER		WALL THICKNESS(t)						CENTER TO END		WEIGHT		
			SCH 10s		SCH 20s		SCH 40		C	M	SCH 10s	SCH 20s	SCH 40
			T ₁	T ₂	T ₁	T ₂	T ₁	T ₂					
150 × 150	165.2	165.2	3.4	3.4	5.0	5.0	7.1	7.1	142.9	142.9	4.70	6.84	9.58
150 × 125	165.2	139.8	3.4	3.4	5.0	5.0	7.1	6.6	142.9	136.5	4.49	6.54	9.08
150 × 100	165.2	114.3	3.4	3.0	5.0	4.0	7.1	6.0	142.9	130.2	4.27	6.16	8.67
150 × 80	165.2	89.1	3.4	3.0	5.0	4.0	7.1	5.5	142.9	123.8	4.14	5.99	8.38
150 × 65	165.2	76.3	3.4	3.0	5.0	3.5	7.1	5.2	142.9	120.7	4.08	5.88	8.25
200 × 200	216.3	216.3	4.0	4.0	6.5	6.5	8.2	8.2	177.8	177.8	8.91	14.30	17.90
200 × 150	216.3	165.2	4.0	3.4	6.5	5.0	8.2	7.1	177.8	168.3	8.26	13.10	16.60
200 × 125	216.3	139.8	4.0	3.4	6.5	5.0	8.2	6.6	177.8	161.9	8.06	12.90	16.10
200 × 100	216.3	114.3	4.0	3.0	6.5	4.0	8.2	6.0	177.8	155.6	7.84	12.50	15.70
200 × 90	216.3	101.6	4.0	3.0	6.5	4.0	8.2	5.7	177.8	152.4	7.80	12.40	15.60
250 × 250	267.4	267.4	4.0	4.0	6.5	6.5	9.3	9.3	215.9	215.9	13.40	21.50	30.40
250 × 200	267.4	216.3	4.0	4.0	6.5	6.5	9.3	8.2	215.9	203.2	12.70	20.40	28.50
250 × 150	267.4	165.2	4.0	3.4	6.5	5.0	9.3	7.1	215.9	193.7	12.00	19.20	27.20
250 × 100	267.4	114.3	4.0	3.0	6.5	4.0	9.3	6.0	215.9	184.2	11.60	18.60	26.40
300 × 300	318.5	318.5	4.5	4.5	6.5	6.5	10.3	10.3	254.0	254.0	21.00	30.10	47.20
300 × 250	318.5	267.4	4.5	4.0	6.5	6.5	10.3	9.3	254.0	241.3	19.80	28.80	44.60
300 × 200	318.5	216.3	4.5	4.0	6.5	6.5	10.3	8.2	254.0	228.6	19.10	27.70	42.70
300 × 150	318.5	165.2	4.5	3.4	6.5	5.0	10.3	7.1	254.0	219.1	18.50	26.60	41.40
300 × 125	318.5	139.8	4.5	3.4	6.5	5.0	10.3	6.6	254.0	215.9	18.30	26.30	41.00
350 × 350	355.6	355.6	4.8	4.8	7.9	7.9	11.1	11.1	279.4	279.4	27.30	44.80	62.40
350 × 300	355.6	318.5	4.8	4.5	7.9	6.5	11.1	10.3	279.4	269.9	25.80	43.20	59.80
350 × 250	355.6	267.4	4.8	4.0	7.9	6.5	11.1	9.3	279.4	257.2	24.70	41.00	57.30
350 × 200	355.6	216.3	4.8	4.0	7.9	6.5	11.1	8.2	279.4	247.7	23.70	39.70	42.00
350 × 150	355.6	165.2	4.8	3.4	7.9	5.0	11.1	7.1	279.4	238.1	22.60	38.00	54.50
400 × 400	406.4	406.4	4.8	4.8	7.9	7.9	12.7	12.7	304.8	304.8	33.80	55.20	87.70
400 × 350	406.4	355.6	4.8	4.8	7.9	7.9	12.7	11.1	304.8	304.8	33.20	54.20	84.70
400 × 300	406.4	318.5	4.8	4.5	7.9	6.5	12.7	10.3	304.8	295.3	32.20	51.90	82.30
400 × 250	406.4	267.4	4.8	4.0	7.9	6.5	12.7	9.3	304.8	282.6	31.00	50.60	79.80
400 × 200	406.4	216.3	4.8	4.0	7.9	6.5	12.7	8.2	304.8	273.1	30.40	49.70	78.10
400 × 150	406.4	165.2	4.8	3.4	7.9	5.0	12.7	7.1	304.8	263.5	29.80	48.50	76.80
450 × 450	457.2	457.2	4.8	4.8	7.9	7.9	14.3	14.3	342.9	342.9	42.70	70.00	125.00
450 × 400	457.2	406.4	4.8	4.8	7.9	7.9	14.3	12.7	342.9	330.2	40.10	67.50	120.10
450 × 350	457.2	355.6	4.8	4.8	7.9	7.9	14.3	11.1	342.9	330.2	38.40	64.70	115.00
450 × 300	457.2	318.5	4.8	4.5	7.9	6.5	14.3	10.3	342.9	320.7	36.80	62.00	114.00
450 × 250	457.2	267.4	4.8	4.0	7.9	6.5	14.3	9.3	342.9	308.0	35.30	59.40	112.00
500 × 500	508.0	508.0	5.5	5.5	9.5	9.5	15.1	15.1	381.0	381.0	60.60	103.80	163.10
500 × 450	508.0	457.2	5.5	4.8	9.5	7.9	15.1	14.3	381.0	368.3	58.00	98.90	157.60
500 × 400	508.0	406.4	5.5	4.8	9.5	7.9	15.1	12.7	381.0	355.6	56.70	96.80	152.30
500 × 350	508.0	355.6	5.5	4.8	9.5	7.9	15.1	11.1	381.0	355.6	56.10	95.80	149.40
500 × 300	508.0	318.5	5.5	4.5	9.5	6.5	15.1	10.3	381.0	346.1	55.10	93.60	147.00
500 × 250	508.0	267.4	5.5	4.0	9.5	6.5	15.1	9.3	381.0	333.4	53.97	92.27	144.49
500 × 200	508.0	216.3	5.5	4.0	9.5	6.5	15.1	8.2	381.0	323.9	53.37	91.30	142.73
550 × 550	558.8	558.8	5.5	5.5	9.5	9.5	15.1	15.1	419.0	419.0	106.00	126.00	198.00
550 × 500	558.8	508.0	5.5	5.5	9.5	9.5	15.1	15.1	419.0	406.0	103.00	123.00	193.00
550 × 450	558.8	457.2	5.5	4.8	9.5	8.0	15.1	14.3	419.0	394.0	101.00	120.00	188.00
550 × 400	558.8	406.4	5.5	4.8	9.5	8.0	15.1	12.7	419.0	381.0	89.90	117.00	183.00
550 × 350	558.8	355.6	5.5	4.8	9.5	8.0	15.1	11.1	419.0	381.0	95.40	114.00	178.00
550 × 300	558.8	323.8	5.5	4.6	9.5	6.5	15.1	10.3	419.0	371.0	91.60	111.00	176.90
550 × 250	558.8	273.1	5.5	4.2	9.5	6.5	15.1	9.3	419.0	359.0	89.60	108.00	124.40

FOR DIMENSIONAL TOLERANCES AND BEVEL DETAILS, SEE PAGE 49, 53.

STAINLESS STEEL BUTT-WELDING FITTINGS

KS B1541 / B1543
JIS B2312 / B2313

UNIT : mm

UNIT : KG

NOMINAL PIPE SIZE	OUTSIDE DIAMETER		WALL THICKNESS(t)						CENTER TO END		WEIGHT		
			SCH 10s		SCH 20s		SCH 40		C	M	SCH 10s	SCH 20s	SCH 40
			T ₁	T ₂	T ₁	T ₂	T ₁	T ₂					
RUN×OUTLET	O.D ₁	O.D ₂											
600 × 600	609.6	609.6	6.4	6.4	9.5	9.5	17.5	15.1	431.0	431.0	94.0	139.0	248.0
600 × 550	609.6	558.8	6.4	5.5	9.5	9.5	17.5	15.1	431.0	431.0	91.0	137.0	246.0
600 × 500	609.6	508.0	6.4	5.5	9.5	9.5	17.5	15.1	431.0	431.0	91.0	136.0	243.0
600 × 450	609.6	457.2	6.4	4.8	9.5	8.0	17.5	14.3	431.0	419.0	88.0	131.0	238.0
600 × 400	609.6	406.4	6.4	4.8	9.5	8.0	17.5	12.7	431.0	406.0	87.0	129.0	233.0
600 × 350	609.6	355.6	6.4	4.6	9.5	8.0	17.5	11.1	431.0	406.0	86.0	128.0	230.0
600 × 300	609.6	323.8	6.4	4.6	9.5	6.5	17.5	10.3	431.0	397.0	85.0	126.0	227.0
600 × 250	609.6	273.1	6.4	4.2	9.5	6.5	17.5	9.3	431.0	384.0	84.0	125.0	225.0
650 × 650	660.4	660.4	7.9	7.9	12.7	9.5	17.5	17.5	495.0	495.0	147.0	226.0	320.0
650 × 600	660.4	609.6	7.9	6.4	12.7	9.5	17.5	15.1	495.0	483.0	140.0	222.0	308.0
650 × 550	660.4	558.8	7.9	5.5	12.7	9.5	17.5	15.1	495.0	470.0	136.0	219.0	303.0
650 × 500	660.4	508.0	7.9	5.5	12.7	9.5	17.5	15.1	495.0	457.0	134.0	216.0	298.0
650 × 450	660.4	457.2	7.9	4.8	12.7	8.0	17.5	14.3	495.0	444.0	132.0	211.0	292.0
650 × 400	660.4	406.4	7.9	4.8	12.7	8.0	17.5	12.7	495.0	432.0	131.0	209.0	287.0
650 × 350	660.4	355.6	7.9	4.8	12.7	8.0	17.5	11.1	495.0	432.0	130.0	208.0	284.0
650 × 300	660.4	323.8	7.9	4.6	12.7	6.5	17.5	10.3	495.0	422.0	129.0	205.0	282.0
700 × 700	711.2	711.2	7.9	7.9	12.7	9.5	17.5	17.5	521.0	521.0	165.0	255.0	361.0
700 × 650	711.2	660.4	7.9	7.9	12.7	9.5	17.5	15.1	521.0	521.0	164.0	253.0	352.0
700 × 600	711.2	609.6	7.9	6.4	12.7	9.5	17.5	15.1	521.0	508.0	157.0	249.0	346.0
700 × 550	711.2	558.8	7.9	5.5	12.7	9.5	17.5	15.1	521.0	495.0	153.0	246.0	340.0
700 × 500	711.2	508.0	7.9	5.5	12.7	9.5	17.5	14.3	521.0	483.0	151.0	243.0	334.0
700 × 450	711.2	457.2	7.9	4.8	12.7	8.0	17.5	12.7	521.0	470.0	149.0	238.0	328.0
700 × 400	711.2	406.4	7.9	4.8	12.7	8.0	17.5	11.1	521.0	457.0	148.0	236.0	323.0
700 × 350	711.2	355.6	7.9	4.8	12.7	8.0	17.5	10.3	521.0	457.0	147.0	235.0	321.0
700 × 300	711.2	323.8	7.9	4.6	12.7	6.5	17.5	9.3	521.0	448.0	146.0	233.0	318.0
750 × 750	762.0	762.0	7.9	7.9	12.7	9.5	17.5	17.5	559.0	559.0	190.0	294.0	416.0
750 × 700	762.0	711.2	7.9	7.9	12.7	9.5	17.5	17.5	559.0	546.0	187.0	289.0	408.0
750 × 650	762.0	660.4	7.9	7.9	12.7	9.5	17.5	17.5	559.0	546.0	185.0	287.0	405.0
750 × 600	762.0	609.6	7.9	6.4	12.7	9.5	17.5	15.1	559.0	533.0	179.0	284.0	393.0
750 × 550	762.0	558.8	7.9	5.5	12.7	9.5	17.5	15.1	559.0	521.0	175.0	280.0	387.0
750 × 500	762.0	508.0	7.9	5.5	12.7	9.5	17.5	15.1	559.0	508.0	173.0	277.0	382.0
750 × 450	762.0	457.2	7.9	4.8	12.7	8.0	17.5	14.3	559.0	495.0	170.0	272.0	377.0
750 × 400	762.0	406.4	7.9	4.8	12.7	8.0	17.5	12.7	559.0	483.0	169.0	270.0	372.0
750 × 350	762.0	355.6	7.9	4.8	12.7	8.0	17.5	11.1	559.0	483.0	168.0	269.0	369.0
750 × 300	762.0	323.8	7.9	4.6	12.7	6.5	17.5	10.3	559.0	473.0	168.0	267.0	366.0
750 × 250	762.0	273.1	7.9	4.2	12.7	6.5	17.5	9.3	559.0	460.0	166.0	266.0	364.0
800 × 800	812.8	812.8	7.9	7.9	12.7	9.5	17.5	17.5	597.0	597.0	217.0	335.0	475.0
800 × 750	812.8	762.0	7.9	7.9	12.7	9.5	17.5	17.5	597.0	584.0	213.0	330.0	467.0
800 × 700	812.8	711.2	7.9	7.9	12.7	9.5	17.5	17.5	597.0	572.0	210.0	326.0	459.0
800 × 650	812.8	660.4	7.9	7.9	12.7	9.5	17.5	17.5	597.0	572.0	208.0	324.0	456.0
800 × 600	812.8	609.6	7.9	6.4	12.7	9.5	15.1	15.1	597.0	559.0	202.0	320.0	388.0
800 × 550	812.8	558.8	7.9	5.5	12.7	9.5	15.1	15.1	597.0	546.0	198.0	317.0	383.0
800 × 500	812.8	508.0	7.9	5.5	12.7	9.5	15.1	15.1	597.0	533.0	196.0	314.0	378.0
800 × 450	812.8	457.2	7.9	4.8	12.7	8.0	14.3	14.3	597.0	521.0	193.0	309.0	354.0
800 × 400	812.8	406.4	7.9	4.8	12.7	8.0	12.7	12.7	597.0	508.0	192.0	307.0	312.0
800 × 350	812.8	355.6	7.9	4.8	12.7	8.0	11.1	11.1	597.0	508.0	191.0	306.0	271.0

FOR DIMENSIONAL TOLERANCES AND BEVEL DETAILS, SEE PAGE 49, 53.

STAINLESS STEEL BUTT-WELDING FITTINGS

TEE

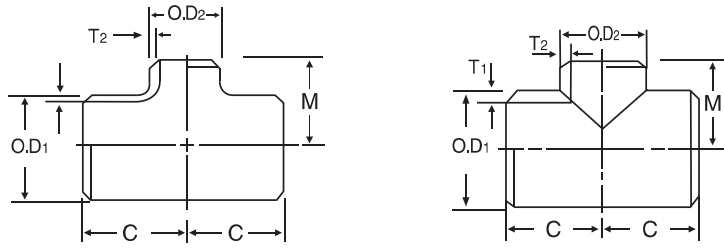

KS B1541 / B1543
JIS B2312 / B2313

UNIT : mm

UNIT : KG

NOMINAL PIPE SIZE	OUTSIDE DIAMETER		WALL THICKNESS(t)						CENTER TO END		WEIGHT		
			SCH 10s		SCH 20s		SCH 40		C	M	SCH 10s	SCH 20s	SCH 40
			T ₁	T ₂	T ₁	T ₂	T ₁	T ₂					
850 × 850	863.6	863.6	7.9	7.9	12.7	9.5	17.5	17.5	635.0	635.0	245.0	379.0	538.0
850 × 800	863.6	812.8	7.9	7.9	12.7	9.5	17.5	17.5	635.0	622.0	241.0	374.0	529.0
850 × 750	863.6	762.0	7.9	7.9	12.7	9.5	17.5	17.5	635.0	610.0	238.0	370.0	521.0
850 × 700	863.6	711.2	7.9	7.9	12.7	9.5	17.5	17.5	635.0	597.0	234.0	365.0	513.0
850 × 650	863.6	660.4	7.9	7.9	12.7	9.5	17.5	17.5	635.0	597.0	233.0	363.0	509.0
850 × 600	863.6	609.6	7.9	6.4	12.7	9.5	17.5	15.1	635.0	584.0	226.0	360.0	497.0
850 × 550	863.6	558.8	7.9	5.5	12.7	9.5	17.5	15.1	635.0	572.0	222.0	356.0	492.0
850 × 500	863.6	508.0	7.9	5.5	12.7	9.5	17.5	15.1	635.0	559.0	220.0	353.0	487.0
850 × 450	863.6	457.2	7.9	4.8	12.7	8.0	17.5	14.3	635.0	546.0	218.0	348.0	481.0
850 × 400	863.6	406.4	7.9	4.8	12.7	8.0	17.5	12.7	635.0	533.0	216.0	346.0	476.0
900 × 900	914.4	914.4	7.9	7.9	12.7	9.5	19.0	17.5	673.0	673.0	276.0	426.0	648.0
900 × 850	914.4	863.6	7.9	7.9	12.7	9.5	19.0	17.5	673.0	660.0	271.0	420.0	638.0
900 × 800	914.4	812.8	7.9	7.9	12.7	9.5	19.0	17.5	673.0	648.0	268.0	416.0	630.0
900 × 750	914.4	762.0	7.9	7.9	12.7	9.5	19.0	17.5	673.0	635.0	264.0	411.0	622.0
900 × 700	914.4	711.2	7.9	7.9	12.7	9.5	19.0	17.5	673.0	622.0	260.0	407.0	614.0
900 × 650	914.4	660.4	7.9	7.9	12.7	9.5	19.0	17.5	673.0	622.0	259.0	405.0	610.0
900 × 600	914.4	609.6	7.9	6.4	12.7	9.5	19.0	15.1	673.0	610.0	252.0	401.0	598.0
900 × 550	914.4	558.8	7.9	5.5	12.7	9.5	19.0	15.1	673.0	597.0	248.0	398.0	593.0
900 × 500	914.4	508.0	7.9	5.5	12.7	9.5	19.0	15.1	673.0	584.0	246.0	395.0	588.0
900 × 450	914.4	457.2	7.9	4.8	12.7	8.0	19.0	14.3	673.0	572.0	244.0	390.0	582.0
900 × 400	914.4	406.4	7.9	4.8	12.7	8.0	19.0	12.7	673.0	559.0	242.0	388.0	577.0
950 × 950	965.2	965.2	7.9	7.9	12.7	9.5	19.0	19.0	711.0	711.0	308.0	475.0	731.0
950 × 850	965.2	914.4	7.9	7.9	12.7	9.5	19.0	19.0	711.0	711.0	305.0	472.0	726.0
950 × 800	965.2	863.6	7.9	7.9	12.7	9.5	19.0	17.5	711.0	698.0	301.0	467.0	709.0
950 × 750	965.2	812.8	7.9	7.9	12.7	9.5	19.0	17.5	711.0	686.0	297.0	462.0	700.0
950 × 700	965.2	762.0	7.9	7.9	12.7	9.5	19.0	17.5	711.0	673.0	293.0	458.0	691.0
950 × 650	965.2	711.2	7.9	7.9	12.7	9.5	19.0	17.5	711.0	648.0	288.0	451.0	680.0
950 × 600	965.2	660.4	7.9	7.9	12.7	9.5	19.0	17.5	711.0	648.0	286.0	449.0	676.0
950 × 550	965.2	609.6	7.9	5.5	12.7	9.5	19.0	15.1	711.0	635.0	278.0	445.0	664.0
950 × 500	965.2	558.8	7.9	5.5	12.7	9.5	19.0	15.1	711.0	622.0	276.0	442.0	658.0
950 × 450	965.2	508.0	7.9	5.5	12.7	9.5	19.0	15.1	711.0	610.0	274.0	439.0	654.0
950 × 400	965.2	457.2	7.9	4.8	12.7	8.0	19.0	14.3	711.0	597.0	271.0	434.0	648.0
1000 × 1000	1016.0	1016.0	9.5	7.9	14.3	9.5	26.2	26.2	749.0	749.0	400.0	586.0	1,112.0
1000 × 950	1016.0	956.2	9.5	7.9	14.3	9.5	26.2	19.0	749.0	749.0	398.0	582.0	1,063.0
1000 × 900	1016.0	914.4	9.5	7.9	14.3	9.5	26.2	19.0	749.0	737.0	393.0	577.0	1,054.0
1000 × 850	1016.0	863.6	9.5	7.9	14.3	9.5	26.2	17.5	749.0	724.0	389.0	572.0	1,036.0
1000 × 800	1016.0	812.8	9.5	7.9	14.3	9.5	26.2	17.5	749.0	711.0	385.0	567.0	1,027.0
1000 × 750	1016.0	762.0	9.5	7.9	14.3	9.5	26.2	17.5	749.0	698.0	381.0	562.0	1,019.0
1000 × 700	1016.0	711.2	9.5	7.9	14.3	9.5	26.2	17.5	749.0	673.0	376.0	556.0	1,007.0
1000 × 650	1016.0	660.4	9.5	7.9	14.3	9.5	26.2	17.5	749.0	673.0	374.0	554.0	1,003.0
1000 × 600	1016.0	609.6	9.5	6.4	14.3	9.5	26.2	15.1	749.0	660.0	368.0	550.0	991.0
1000 × 550	1016.0	558.8	9.5	5.5	14.3	9.5	26.2	15.1	749.0	648.0	364.0	547.0	986.0
1000 × 500	1016.0	508.0	9.5	5.5	14.3	9.5	26.2	15.1	749.0	635.0	362.0	544.0	981.0
1000 × 450	1016.0	457.2	9.5	4.8	14.3	8.0	26.2	14.3	749.0	622.0	359.0	539.0	975.0

FOR DIMENSIONAL TOLERANCES AND BEVEL DETAILS, SEE PAGE 49, 53.

STAINLESS STEEL BUTT-WELDING FITTINGS

KS B1541 / B1543
JIS B2312 / B2313

UNIT : mm

UNIT : KG

NOMINAL PIPE SIZE	OUTSIDE DIAMETER		WALL THICKNESS(t)						CENTER TO END		WEIGHT		
			SCH 10s		SCH 20s		SCH 40		C	M	SCH 10s	SCH 20s	SCH 40
			T ₁	T ₂	T ₁	T ₂	T ₁	T ₂					
RUN×OUTLET	O.D ₁	O.D ₂	T ₁	T ₂	T ₁	T ₂	T ₁	T ₂	C	M	SCH 10s	SCH 20s	SCH 40
1050 × 1050	1066.8	1066.8	9.5	9.5	14.3	14.3	26.2	26.2	762.0	711.0	421.0	631.0	1,144.0
1050 × 1000	1066.8	1016.0	9.5	9.5	14.3	14.3	26.2	26.2	762.0	711.0	419.0	628.0	1,138.0
1050 × 950	1066.8	965.2	9.5	7.9	14.3	9.5	26.2	19.0	762.0	711.0	410.0	605.0	1,103.0
1050 × 900	1066.8	914.4	9.5	7.9	14.3	9.5	26.2	19.0	762.0	711.0	409.0	603.0	1,099.0
1050 × 850	1066.8	863.6	9.5	7.9	14.3	9.5	26.2	17.5	762.0	711.0	407.0	601.0	1,089.0
1050 × 800	1066.8	812.8	9.5	7.9	14.3	9.5	26.2	17.5	762.0	711.0	405.0	599.0	1,085.0
1050 × 750	1066.8	762.0	9.5	7.9	14.3	9.5	26.2	17.5	762.0	711.0	403.0	597.0	1,081.0
1050 × 700	1066.8	711.2	9.5	7.9	14.3	9.5	26.2	17.5	762.0	698.0	400.0	592.0	1,073.0
1050 × 650	1066.8	660.4	9.5	7.9	14.3	9.5	26.2	17.5	762.0	698.0	398.0	590.0	1,070.0
1050 × 600	1066.8	609.6	9.5	6.4	14.3	9.5	26.2	15.1	762.0	660.0	389.0	583.0	1,052.0
1050 × 550	1066.8	558.8	9.5	5.5	14.3	9.5	26.2	15.1	762.0	660.0	387.0	582.0	1,050.0
1050 × 500	1066.8	508.0	9.5	5.5	14.3	9.5	26.2	15.1	762.0	660.0	386.0	580.0	1,047.0
1050 × 450	1066.8	457.2	9.5	4.8	14.3	9.5	26.2	14.3	762.0	648.0	383.0	577.0	1,042.0
1050 × 400	1066.8	406.4	9.5	4.8	14.3	8.0	26.2	12.7	762.0	635.0	382.0	573.0	1,037.0
1100 × 1100	1117.6	1117.6	9.5	9.5	14.3	14.3	26.2	26.2	813.0	762.0	475.0	711.0	1,289.0
1100 × 1050	1117.6	1066.8	9.5	9.5	14.3	14.3	26.2	26.2	813.0	762.0	472.0	708.0	1,283.0
1100 × 1000	1117.6	1060.0	9.5	9.5	14.3	14.3	26.2	26.2	813.0	749.0	469.0	702.0	1,273.0
1100 × 950	1117.6	965.2	9.5	7.9	14.3	9.5	26.2	19.0	813.0	737.0	455.0	672.0	1,225.0
1100 × 900	1117.6	914.4	9.5	7.9	14.3	9.5	26.2	19.0	813.0	724.0	451.0	667.0	1,215.0
1100 × 850	1117.6	863.6	9.5	7.9	14.3	9.5	26.2	17.5	813.0	724.0	449.0	665.0	1,206.0
1100 × 800	1117.6	812.8	9.5	7.9	14.3	9.5	26.2	17.5	813.0	711.0	446.0	661.0	1,198.0
1100 × 750	1117.6	762.0	9.5	7.9	14.3	9.5	26.2	17.5	813.0	711.0	444.0	659.0	1,195.0
1100 × 700	1117.6	711.2	9.5	7.9	14.3	9.5	26.2	17.5	813.0	698.0	441.0	655.0	1,188.0
1100 × 650	1117.6	660.4	9.5	7.9	14.3	9.5	26.2	17.5	813.0	698.0	440.0	654.0	1,185.0
1100 × 600	1117.6	609.6	9.5	6.4	14.3	9.5	26.2	15.1	813.0	698.0	435.0	652.0	1,177.0
1100 × 550	1117.6	558.8	9.5	5.5	14.3	9.5	26.2	15.1	813.0	686.0	431.0	649.0	1,172.0
1100 × 500	1117.6	508.0	9.5	5.5	14.3	9.5	26.2	15.1	813.0	686.0	431.0	647.0	1,169.0
1150 × 1150	1168.4	1168.4	9.5	9.5	14.3	14.3	26.2	26.2	851.0	800.0	520.0	780.0	1,415.0
1150 × 1100	1168.4	1117.6	9.5	9.5	14.3	14.3	26.2	26.2	851.0	800.0	518.0	776.0	1,408.0
1150 × 1050	1168.4	1066.8	9.5	9.5	14.3	14.3	26.2	26.2	851.0	787.0	512.0	768.0	1,392.0
1150 × 1000	1168.4	1016.0	9.5	9.5	14.3	14.3	26.2	26.2	851.0	775.0	507.0	760.0	1,377.0
1150 × 950	1168.4	965.2	9.5	7.9	14.3	9.5	26.2	19.0	851.0	762.0	495.0	732.0	1,334.0
1150 × 900	1168.4	914.4	9.5	7.9	14.3	9.5	26.2	19.0	851.0	762.0	493.0	730.0	1,330.0
1150 × 850	1168.4	863.6	9.5	7.9	14.3	9.5	26.2	17.5	851.0	749.0	489.0	725.0	1,316.0
1150 × 800	1168.4	812.8	9.5	7.9	14.3	9.5	26.2	17.5	851.0	749.0	488.0	723.0	1,312.0
1150 × 750	1168.4	762.0	9.5	7.9	14.3	9.5	26.2	17.5	851.0	737.0	484.0	719.0	1,305.0
1150 × 700	1168.4	711.2	9.5	7.9	14.3	9.5	26.2	17.5	851.0	737.0	483.0	717.0	1,301.0
1150 × 650	1168.4	660.4	9.5	7.9	14.3	9.5	26.2	17.5	851.0	737.0	481.0	716.0	1,298.0
1150 × 600	1168.4	609.6	9.5	6.4	14.3	9.5	26.2	15.1	851.0	724.0	475.0	712.0	1,286.0
1150 × 550	1168.4	558.8	9.5	5.5	14.3	9.5	26.2	15.1	851.0	724.0	472.0	710.0	1,284.0
1200 × 1200	1219.2	1219.2	9.5	7.9	14.3	14.3	26.2	26.2	889.0	838.0	558.0	852.0	1,546.0
1200 × 1150	1219.2	1168.4	9.5	7.9	14.3	14.3	26.2	26.2	889.0	838.0	555.0	848.0	1,538.0
1200 × 1100	1219.2	1117.6	9.5	7.9	14.3	14.3	26.2	26.2	889.0	838.0	553.0	844.0	1,531.0
1200 × 1050	1219.2	1066.8	9.5	7.9	14.3	14.3	26.2	26.2	889.0	831.0	549.0	837.0	1,519.0
1200 × 1000	1219.2	1016.0	9.5	7.9	14.3	14.3	26.2	26.2	889.0	813.0	544.0	827.0	1,500.0
1200 × 950	1219.2	965.2	9.5	7.9	14.3	9.5	26.2	19.0	889.0	813.0	542.0	801.0	1,460.0
1200 × 900	1219.2	914.4	9.5	7.9	14.3	9.5	26.2	19.0	889.0	813.0	540.0	798.0	1,455.0
1200 × 850	1219.2	863.6	9.5	7.9	14.3	9.5	26.2	17.5	889.0	787.0	533.0	791.0	1,435.0
1200 × 800	1219.2	812.8	9.5	7.9	14.3	9.5	26.2	17.5	889.0	787.0	531.0	788.0	1,431.0
1200 × 750	1219.2	762.0	9.5	7.9	14.3	9.5	26.2	17.5	889.0	787.0	530.0	786.0	1,427.0
1200 × 700	1219.2	711.2	9.5	7.9	14.3	9.5	26.2	17.5	889.0	762.0	525.0	780.0	1,415.0
1200 × 650	1219.2	660.4	9.5	7.9	14.3	9.5	26.2	17.5	889.0	762.0	523.0	788.0	1,412.0
1200 × 600	1219.2	609.6	9.5	6.4	14.3	9.5	26.2	15.1	889.0	762.0	518.0	777.0	1,404.0
1200 × 550	1219.2	558.8	9.5	5.5	14.3	9.5	26.2	15.1	889.0	737.0	513.0	772.0	1,396.0

FOR DIMENSIONAL TOLERANCES AND BEVEL DETAILS, SEE PAGE 49, 53.

STAINLESS STEEL BUTT-WELDING FITTINGS

REDUCER (CONCENTRIC & ECCENTRIC)

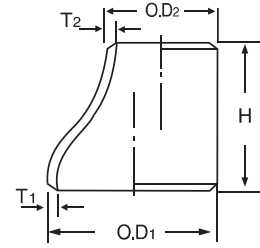
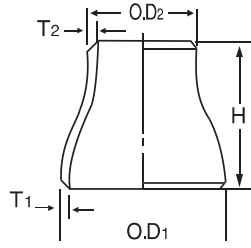

KS B1541 / B1543
JIS B2312 / B2313

UNIT : mm

UNIT : KG

NOMINAL PIPE SIZE	OUTSIDE DIAMETER		WALL THICKNESS(t)						CENTER TO END	WEIGHT		
	RUN×OUTLET	O.D ₁	O.D ₂	SCH 10s		SCH 20s		SCH 40		H	SCH 10s	SCH 20s
T ₁				T ₂	T ₁	T ₂	T ₁	T ₂				
20 × 15	27.2	21.7	2.1	2.1	2.5	2.5	2.9	2.8	38.1	0.04	0.05	0.06
25 × 20	34.0	27.2	2.8	2.1	3.0	2.5	3.4	2.9	50.8	0.10	0.10	0.12
25 × 15	34.0	21.7	2.8	2.1	3.0	2.5	3.4	2.8	50.8	0.09	0.09	0.11
32 × 25	42.7	34.0	2.8	2.8	3.0	3.0	3.6	3.4	50.8	0.13	0.13	0.16
32 × 20	42.7	27.2	2.8	2.1	3.0	2.5	3.6	2.9	50.8	0.11	0.12	0.14
32 × 15	42.7	21.7	2.8	2.1	3.0	2.5	3.6	2.8	50.8	0.10	0.11	0.13
40 × 32	48.6	42.7	2.8	2.8	3.0	3.0	3.7	3.6	63.5	0.19	0.20	0.24
40 × 25	48.6	34.0	2.8	2.8	3.0	3.0	3.7	3.4	63.5	0.17	0.18	0.22
40 × 20	48.6	27.2	2.8	2.1	3.0	2.5	3.7	2.9	63.5	0.16	0.17	0.20
40 × 15	48.6	21.7	2.8	2.1	3.0	2.5	3.7	2.8	63.5	0.14	0.15	0.18
50 × 40	60.5	48.6	2.8	2.8	3.5	3.0	3.9	3.7	76.2	0.27	0.34	0.37
50 × 32	60.5	42.7	2.8	2.8	3.5	3.0	3.9	3.6	76.2	0.26	0.32	0.35
50 × 25	60.5	34.0	2.8	2.8	3.5	3.0	3.9	3.4	76.2	0.24	0.29	0.32
50 × 20	60.5	27.2	2.8	2.1	3.5	2.5	3.9	2.9	76.2	0.21	0.25	0.29
65 × 50	76.3	60.5	3.0	2.8	3.5	3.5	5.2	3.9	88.9	0.43	0.50	0.72
65 × 40	76.3	48.6	3.0	2.8	3.5	3.0	5.2	3.7	88.9	0.40	0.46	0.66
65 × 32	76.3	42.7	3.0	2.8	3.5	3.0	5.2	3.6	88.9	0.38	0.43	0.61
65 × 25	76.3	34.0	3.0	2.8	3.5	3.0	5.2	3.4	76.2	0.29	0.34	0.49
80 × 65	89.1	76.3	3.0	3.0	4.0	3.5	5.5	5.2	88.9	0.53	0.69	0.93
80 × 50	89.1	60.5	3.0	2.8	4.0	3.5	5.5	3.9	88.9	0.48	0.63	0.85
80 × 40	89.1	48.6	3.0	2.8	4.0	3.0	5.5	3.7	88.9	0.44	0.58	0.78
90 × 80	101.6	89.1	3.0	3.0	4.0	4.0	5.7	5.5	101.6	0.70	0.91	1.28
90 × 65	101.6	76.3	3.0	3.0	4.0	3.5	5.7	5.3	101.6	0.66	0.85	1.22
90 × 50	101.6	60.5	3.0	2.8	4.0	3.5	5.7	3.9	101.6	0.61	0.80	1.16
90 × 40	101.6	48.6	3.0	2.8	4.0	3.0	5.7	3.7	101.6	0.57	0.76	1.11
90 × 32	101.6	42.7	3.0	2.8	4.0	3.0	5.7	3.6	101.6	0.52	0.72	1.06
100 × 80	114.3	89.1	3.0	3.0	4.0	4.0	6.0	5.5	101.6	0.75	0.99	1.45
100 × 65	114.3	76.3	3.0	3.0	4.0	3.5	6.0	5.2	101.6	0.71	0.93	1.37
100 × 50	114.3	60.5	3.0	2.8	4.0	3.5	6.0	3.9	101.6	0.66	0.86	1.27
100 × 40	114.3	48.6	3.0	2.8	4.0	3.0	6.0	3.7	101.6	0.60	0.79	1.12
125 × 100	139.8	114.3	3.4	3.0	5.0	4.0	6.6	6.0	127.0	1.32	1.92	2.50
125 × 80	139.8	89.1	3.4	3.0	5.0	4.0	6.6	5.5	127.0	1.20	1.74	2.27
125 × 65	139.8	76.3	3.4	3.0	5.0	3.5	6.6	5.2	127.0	1.15	1.66	2.16
125 × 50	139.8	60.5	3.4	2.8	5.0	3.5	6.6	3.9	127.0	1.03	1.49	1.93
150 × 125	165.2	139.8	3.4	3.4	5.0	5.0	7.1	6.6	139.7	1.75	2.55	3.57
150 × 100	165.2	114.3	3.4	3.0	5.0	4.0	7.1	6.0	139.7	1.62	2.36	3.30
150 × 80	165.2	89.1	3.4	3.0	5.0	4.0	7.1	5.5	139.7	1.50	2.18	3.04
150 × 65	165.2	76.3	3.4	3.0	5.0	3.5	7.1	5.2	139.7	1.37	1.99	2.78
200 × 150	216.3	165.2	4.0	3.4	6.5	5.0	8.2	7.1	152.4	2.85	4.57	5.71
200 × 125	216.3	139.8	4.0	3.4	6.5	5.0	8.2	6.6	152.4	2.70	4.33	5.40
200 × 100	216.3	114.3	4.0	3.0	6.5	6.5	8.2	6.0	152.4	2.56	4.10	5.10
200 × 90	216.3	101.6	4.0	3.0	6.5	4.0	8.2	5.7	152.4	2.33	3.72	4.64

FOR DIMENSIONAL TOLERANCES AND BEVEL DETAILS, SEE PAGE 49, 53.

STAINLESS STEEL BUTT-WELDING FITTINGS

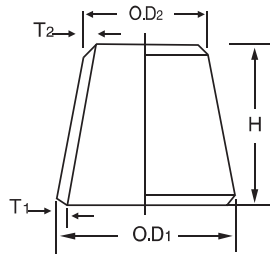

UNIT : mm

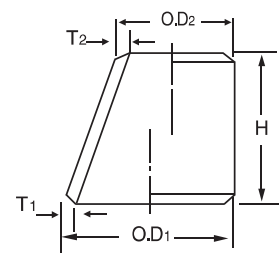

UNIT : KG

KS B1541 / B1543
JIS B2312 / B2313

NOMINAL PIPE SIZE	OUTSIDE DIAMETER		WALL THICKNESS(t)						CENTER TO END	WEIGHT		
	O.D ₁	O.D ₂	SCH 10s		SCH 20s		SCH 40		H	SCH 10s	SCH 20s	SCH 40
			T ₁	T ₂	T ₁	T ₂	T ₁	T ₂				
250 × 200	267.4	216.3	4.0	4.0	6.5	6.5	9.3	8.2	177.8	4.17	6.70	9.48
250 × 150	267.4	165.2	4.0	3.4	6.5	5.0	9.3	7.1	177.8	3.72	5.98	8.44
250 × 125	267.4	139.8	4.0	3.4	6.5	5.0	9.3	6.6	177.8	3.50	5.61	7.92
250 × 100	267.4	114.3	4.0	3.0	6.5	4.0	9.3	6.0	177.8	3.28	5.25	7.40
300 × 250	318.5	267.4	4.5	4.0	6.5	6.5	10.3	9.3	203.2	6.50	9.33	14.58
300 × 200	318.5	216.3	4.5	4.0	6.5	6.5	10.3	8.2	203.2	5.93	8.49	13.26
300 × 150	318.5	165.2	4.5	3.4	6.5	5.0	10.3	7.1	203.2	5.35	7.66	11.95
300 × 125	318.5	139.8	4.5	3.4	6.5	5.0	10.3	6.6	203.2	5.06	7.25	11.29
350 × 300	355.6	318.5	4.8	4.5	7.9	6.5	11.1	10.3	330.2	12.98	21.16	29.45
350 × 250	355.6	267.4	4.8	4.0	7.9	6.5	11.1	9.3	330.2	11.98	19.52	27.14
350 × 200	355.6	216.3	4.8	4.0	7.9	6.5	11.1	8.2	330.2	10.98	17.88	24.83
350 × 150	355.6	165.2	4.8	3.4	7.9	5.0	11.1	7.1	330.2	9.99	16.24	22.52
400 × 350	406.4	355.6	4.8	4.8	7.9	7.9	12.7	11.1	355.6	15.83	25.84	41.00
400 × 300	406.4	318.5	4.8	4.5	7.9	6.5	12.7	10.3	355.6	15.05	24.55	38.93
400 × 250	406.4	267.4	4.8	4.0	7.9	6.5	12.7	9.3	355.6	13.97	22.78	36.09
400 × 200	406.4	216.3	4.8	4.0	7.9	6.5	12.7	8.2	355.6	12.90	21.01	33.25
450 × 400	457.2	406.4	4.8	4.8	7.9	7.9	14.3	12.7	381.0	19.25	31.45	56.07
450 × 350	457.2	355.6	4.8	4.8	7.9	7.9	14.3	11.1	381.0	18.10	29.57	52.66
450 × 300	457.2	318.5	4.8	4.5	7.9	6.5	14.3	10.3	381.0	17.27	28.19	50.17
450 × 250	457.2	267.4	4.8	4.0	7.9	6.5	14.3	9.3	381.0	16.12	26.29	46.73
500 × 450	508.0	457.2	5.5	4.8	9.5	7.9	15.1	14.3	508.0	32.86	56.28	88.39
500 × 400	508.0	406.4	5.5	4.8	9.5	7.9	15.1	12.7	508.0	31.11	53.26	83.59
500 × 350	508.0	355.8	5.5	4.8	9.5	7.9	15.1	11.1	508.0	29.37	50.25	78.81
500 × 300	508.0	318.5	5.5	4.5	9.5	6.5	15.1	10.3	508.0	28.08	48.03	75.28
550 × 500	558.8	508.0	5.5	5.5	9.5	9.5	15.1	15.1	508.0	36.36	62.32	98.00
550 × 450	558.8	457.2	5.5	4.8	9.5	8.0	15.1	14.3	508.0	34.61	59.30	93.20
550 × 400	558.8	406.4	5.5	4.8	9.5	8.0	15.1	12.7	508.0	32.86	56.28	88.39
550 × 350	558.8	355.5	5.5	4.8	9.5	8.0	15.1	11.1	508.0	31.10	53.25	83.58
600 × 550	609.6	558.8	6.4	5.5	9.5	9.5	17.5	15.1	508.0	46.30	68.36	124.18
600 × 500	609.6	508.0	6.4	5.5	9.5	9.5	17.5	15.1	508.0	44.27	65.34	118.61
600 × 450	609.6	457.2	6.4	4.8	9.5	8.0	17.5	14.3	508.0	42.23	62.32	113.05
600 × 400	609.6	406.4	6.4	4.8	9.5	8.0	17.5	12.7	508.0	40.20	59.30	107.48
650 × 600	660.4	609.6	7.9	6.4	12.7	9.5	17.5	15.1	609.6	74.44	118.75	162.38
650 × 550	660.4	558.8	7.9	5.5	12.7	9.5	17.5	15.1	609.6	71.43	113.91	155.70
650 × 500	660.4	508.0	7.9	5.5	12.7	9.5	17.5	15.1	609.6	68.41	109.06	149.02
650 × 450	660.4	457.2	7.9	4.8	12.7	8.0	17.5	14.3	609.6	65.39	104.21	142.34
700 × 650	711.2	660.4	7.9	7.9	12.7	12.7	17.5	15.1	609.6	80.47	128.45	175.73
700 × 600	711.2	609.6	7.9	6.4	12.7	9.5	17.5	15.1	609.6	77.46	123.60	169.05
700 × 550	711.2	558.8	7.9	5.5	12.7	9.5	17.5	15.1	609.6	74.44	118.75	162.38
700 × 500	711.2	508.0	7.9	5.5	12.7	9.5	17.5	14.3	609.6	71.43	113.91	155.70
700 × 450	711.2	457.2	7.9	4.8	12.7	8.0	17.5	12.7	609.6	68.41	109.06	149.02
750 × 700	762.0	711.2	7.9	7.9	12.7	12.7	17.5	17.5	609.6	86.50	138.14	189.09
750 × 650	762.0	660.4	7.9	7.9	12.7	12.7	17.5	17.5	609.6	83.49	133.30	182.41
750 × 600	762.0	609.6	7.9	6.4	12.7	9.5	17.5	15.1	609.6	80.47	128.45	175.73
750 × 550	762.0	558.8	7.9	5.5	12.7	9.5	17.5	15.1	609.6	77.46	123.60	169.05
750 × 500	762.0	508.0	7.9	5.5	12.7	9.5	17.5	15.1	609.6	74.44	118.75	162.38
800 × 750	812.8	762.0	7.9	7.9	12.7	12.7	17.5	17.5	609.6	92.53	147.84	202.45
800 × 700	812.8	711.2	7.9	7.9	12.7	12.7	17.5	17.5	609.6	89.52	142.99	195.77
800 × 650	812.8	660.4	7.9	7.9	12.7	12.7	17.5	17.5	609.6	86.50	138.14	189.09
800 × 600	812.8	609.6	7.9	6.4	12.7	9.5	17.5	15.1	609.6	83.49	133.30	182.41

FOR DIMENSIONAL TOLERANCES AND BEVEL DETAILS, SEE PAGE 49, 53.

STAINLESS STEEL BUTT-WELDING FITTINGS

REDUCER

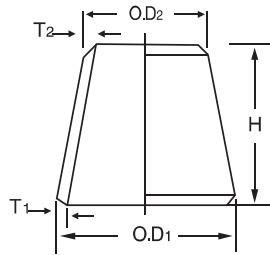

UNIT : mm

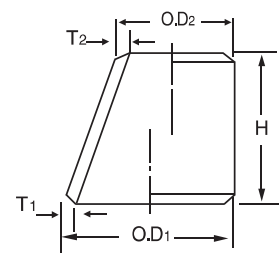

UNIT : KG

KS B1541 / B1543
JIS B2312 / B2313

NOMINAL PIPE SIZE	OUTSIDE DIAMETER		WALL THICKNESS(t)						CENTER TO END	WEIGHT			
	O.D ₁	O.D ₂	SCH 10s		SCH 20s		SCH 40			H	SCH 10s	SCH 20s	SCH 40
			T ₁	T ₂	T ₁	T ₂	T ₁	T ₂					
850 × 800	863.6	812.8	7.9	7.9	12.7	12.7	17.5	17.5	609.6	98.56	157.53	215.81	
850 × 750	863.6	762.0	7.9	7.9	12.7	12.7	17.5	17.5	609.6	95.55	152.68	209.13	
850 × 700	863.6	711.2	7.9	7.9	12.7	12.7	17.5	17.5	609.6	92.53	147.84	202.45	
850 × 650	863.6	660.4	7.9	7.9	12.7	12.7	17.5	17.5	609.6	89.52	142.99	195.77	
850 × 600	863.6	609.6	7.9	6.4	12.7	9.5	17.5	15.1	609.6	86.50	138.14	189.09	
900 × 850	914.4	863.6	7.9	7.9	12.7	12.7	19.0	17.5	609.6	104.59	167.22	248.38	
900 × 800	914.4	812.8	7.9	7.9	12.7	12.7	19.0	17.5	609.6	101.58	162.38	241.13	
900 × 750	914.4	762.0	7.9	7.9	12.7	12.7	19.0	17.5	609.6	98.56	157.53	233.88	
900 × 700	914.4	711.2	7.9	7.9	12.7	12.7	19.0	17.5	609.6	95.55	152.68	226.63	
900 × 650	914.4	660.4	7.9	7.9	12.7	12.7	19.0	17.5	609.6	92.53	147.84	219.37	
900 × 600	914.4	609.6	7.9	6.4	12.7	9.5	19.0	15.1	609.6	89.52	142.99	212.12	
900 × 500	914.4	508.0	7.9	5.5	12.7	9.5	19.0	15.1	609.6	83.49	133.30	197.62	
950 × 900	965.2	914.4	7.9	7.9	12.7	12.7	19.0	19.0	609.6	110.62	176.92	—	
950 × 850	965.2	863.6	7.9	7.9	12.7	12.7	19.0	17.5	609.6	107.61	172.07	—	
950 × 800	965.2	812.8	7.9	7.9	12.7	12.7	19.0	17.5	609.6	104.59	167.22	—	
950 × 750	965.2	762.0	7.9	7.9	12.7	12.7	19.0	17.5	609.6	101.58	162.38	—	
950 × 700	965.2	711.2	7.9	7.9	12.7	12.7	19.0	17.5	609.6	98.56	157.53	—	
950 × 650	965.2	660.4	7.9	7.9	12.7	12.7	19.0	17.5	609.6	95.55	152.68	—	
1000 × 950	1016.0	965.2	9.5	7.9	14.3	12.7	26.2	19.0	609.6	140.05	209.78	—	
1000 × 900	1016.0	914.4	9.5	7.9	14.3	12.7	26.2	19.0	609.6	136.42	204.32	—	
1000 × 850	1016.0	863.6	9.5	7.9	14.3	12.7	26.2	17.5	609.6	132.80	198.86	—	
1000 × 800	1016.0	812.8	9.5	7.9	14.3	12.7	26.2	17.5	609.6	129.17	193.41	—	
1000 × 750	1016.0	762.0	9.5	7.9	14.3	12.7	26.2	17.5	609.6	125.55	187.95	—	
1050 × 1000	1066.8	1016.0	9.5	9.5	14.3	14.3	26.2	26.2	609.6	147.30	220.70	—	
1050 × 950	1066.8	965.2	9.5	7.9	14.3	12.7	26.2	19.0	609.6	143.68	215.24	—	
1050 × 900	1066.8	914.4	9.5	7.9	14.3	12.7	26.2	19.0	609.6	140.05	209.78	—	
1050 × 850	1066.8	863.6	9.5	7.9	14.3	12.7	26.2	17.5	609.6	136.42	204.32	—	
1050 × 800	1066.8	812.8	9.5	7.9	14.3	12.7	26.2	17.5	609.6	132.80	198.86	—	
1050 × 750	1066.8	762.0	9.5	7.9	14.3	12.7	26.2	17.5	609.6	129.17	193.41	—	
1100 × 1050	1117.6	1066.8	9.5	9.5	14.3	14.3	26.2	26.2	609.6	154.55	231.61	—	
1100 × 1000	1117.6	1016.0	9.5	9.5	14.3	14.3	26.2	26.2	609.6	150.93	226.15	—	
1100 × 950	1117.6	965.2	9.5	7.9	14.3	12.7	26.2	19.0	609.6	147.30	220.70	—	
1100 × 900	1117.6	914.4	9.5	7.9	14.3	12.7	26.2	19.0	609.6	143.68	215.24	—	
1150 × 1100	1168.4	1117.6	9.5	9.5	14.3	14.3	26.2	26.2	711.2	188.77	282.95	—	
1150 × 1050	1168.4	1066.8	9.5	9.5	14.3	14.3	26.2	26.2	711.2	184.54	276.58	—	
1150 × 1000	1168.4	1016.0	9.5	9.5	14.3	14.3	26.2	26.2	711.2	180.31	270.21	—	
1150 × 950	1168.4	965.2	9.5	7.9	14.3	12.7	26.2	19.0	711.2	176.08	263.85	—	
1200 × 1150	1219.2	1168.4	9.5	9.5	14.3	14.3	26.2	26.2	711.2	197.23	295.68	—	
1200 × 1100	1219.2	1117.6	9.5	9.5	14.3	14.3	26.2	26.2	711.2	193.00	289.31	—	
1200 × 1050	1219.2	1066.8	9.5	9.5	14.3	14.3	26.2	26.2	711.2	188.77	282.95	—	
1200 × 1000	1219.2	1016.0	9.5	9.5	14.3	14.3	26.2	26.2	711.2	184.54	276.58	—	

FOR DIMENSIONAL TOLERANCES AND BEVEL DETAILS, SEE PAGE 49, 53.

STAINLESS STEEL BUTT-WELDING FITTINGS

180° ELBOW (LONG)

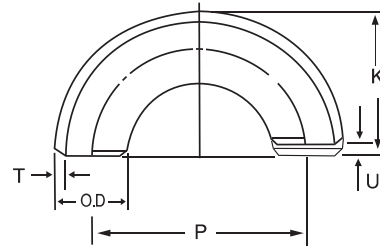

KS B1541 / B1543
JIS B2312 / B2313

UNIT : mm

UNIT : KG

NOMINAL PIPE SIZE	OUTSIDE DIAMETER (O.D)	WALL THICKNESS(t)			CENTER TO END	BACK TO FACE	WEIGHT		
		SCH 10s	SCH 20s	SCH 40	P	K	SCH 10s	SCH 20s	SCH 40
15	21.7	2.1	2.5	2.8	76.2	49.0	0.12	0.15	0.02
20	27.2	2.1	2.5	2.9	76.2	51.7	0.16	0.18	0.21
25	34.0	2.8	3.0	3.4	76.2	55.1	0.26	0.31	0.31
32	42.7	2.8	3.0	3.6	95.2	69.0	0.43	0.53	0.53
40	48.6	2.8	3.0	3.7	114.4	81.5	0.58	0.61	0.75
50	60.5	2.8	3.5	3.9	152.4	106.5	0.99	1.16	1.32
65	76.3	3.0	3.5	5.2	190.6	133.5	1.65	1.89	2.77
80	89.1	3.0	4.0	5.5	228.6	158.9	2.29	3.02	4.10
90	101.6	3.0	4.0	5.7	266.8	184.2	3.08	4.04	5.67
100	114.3	3.0	4.0	6.0	304.8	209.6	3.96	5.23	7.72
125	139.8	3.4	5.0	6.6	381.0	260.4	6.87	9.99	13.02
150	165.2	3.4	5.0	7.1	457.2	311.2	9.79	14.30	19.98
200	216.3	4.0	6.5	8.2	609.6	413.0	20.10	32.40	40.40
250	267.4	4.0	6.5	9.3	762.0	514.7	31.20	50.30	71.20
300	318.5	4.5	6.5	10.3	914.4	616.5	52.10	72.60	114.00
350	355.6	4.8	7.9	11.1	1,066.8	711.2	69.20	113.80	160.20
400	406.4	4.8	7.9	12.7	1,219.2	812.8	90.60	149.00	239.20
450	457.2	4.8	7.9	14.3	1,371.6	914.4	117.00	191.10	341.10
500	508.2	5.5	9.5	15.1	1,524.0	1,016.0	165.40	283.40	445.40
550	558.8	5.5	9.5	15.9	1,676.4	1,117.6	200.30	343.50	568.30
600	609.6	6.4	9.5	17.5	1,828.8	1,219.2	275.10	409.40	744.10

FOR DIMENSIONAL TOLERANCES AND BEVEL DETAILS, SEE PAGE 49, 53.

STAINLESS STEEL BUTT-WELDING FITTINGS

CAP

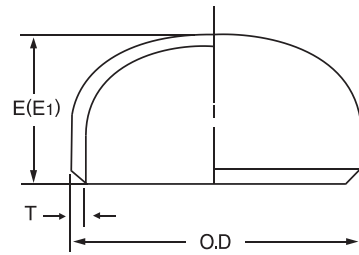

KS B1541 / B1543
JIS B2312 / B2313

UNIT : mm

UNIT : KG

NOMINAL PIPE SIZE	OUTSIDE DIAMETER (O.D)	WALL THICKNESS(t)			OVER ALL LENGTH		LIMITED WALL THICKNESS	WEIGHT		
		SCH 10s	SCH 20s	SCH 40	E	E1	T	SCH 10s	SCH 20s	SCH 40
15	21.7	2.1	2.5	2.8	25.4	—	—	0.03	0.03	0.04
20	27.2	2.1	2.5	2.9	25.4	—	—	0.04	0.04	0.05
25	34.0	2.8	3.0	3.4	38.1	—	—	0.09	0.10	0.11
32	42.7	2.8	3.0	3.6	38.1	—	—	0.11	0.12	0.14
40	48.6	2.8	3.0	3.7	38.1	—	—	0.13	0.14	0.17
50	60.5	2.8	3.5	3.9	38.1	44.5	5.5	0.17	0.21	0.24
65	76.3	3.0	3.5	5.2	38.1	50.8	7.0	0.23	0.28	0.42
80	89.1	3.0	4.0	5.5	50.8	63.5	7.6	0.37	0.48	0.67
90	101.6	3.0	4.0	5.7	63.5	76.2	8.1	0.55	0.70	1.13
100	114.3	3.0	4.0	6.0	63.5	76.2	8.6	0.59	0.78	1.17
125	139.8	3.4	5.0	6.6	76.2	88.9	9.5	0.99	1.44	1.90
150	165.2	3.4	5.0	7.1	88.9	101.6	11.0	1.39	1.99	2.83
200	216.3	4.0	6.5	8.2	101.6	127.0	12.7	2.38	4.05	5.11
250	267.4	4.0	6.5	9.3	127.0	152.4	12.7	4.13	6.23	8.92
300	318.5	4.5	6.5	10.3	152.4	177.8	12.7	6.39	8.89	13.10
350	355.6	4.8	7.9	11.1	165.1	190.5	12.7	7.99	13.20	18.60
400	406.4	4.8	7.9	12.7	177.8	203.2	12.7	10.10	16.70	26.70
450	457.2	4.8	7.9	14.3	203.2	228.6	12.7	12.90	21.30	41.50
500	508.0	5.5	9.5	15.1	228.6	254.0	12.7	18.50	31.80	51.30
550	558.8	5.5	9.5	15.1	254.0	254.0	—	22.60	38.80	65.80
600	609.6	6.4	9.5	17.4	266.7	305.0	—	30.10	45.10	84.20
650	660.4	7.9	12.7	17.4	267.0	305.0	12.7	41.90	67.30	100.00
700	711.2	7.9	12.7	17.4	267.0	305.0	12.7	46.60	74.90	110.80
750	762.0	7.9	12.7	17.4	267.0	305.0	12.7	51.60	82.90	122.10
800	812.8	7.9	12.7	17.4	267.0	305.0	12.7	56.80	91.30	134.00
850	863.6	7.9	12.7	17.4	267.0	305.0	12.7	62.30	100.10	146.50
900	914.4	7.9	12.7	19.0	267.0	305.0	12.7	68.00	109.30	174.20
950	965.2	7.9	12.7	19.0	305.0	305.0	12.7	78.60	126.30	—
1,000	1016.0	9.5	14.3	26.2	305.0	305.0	12.7	102.20	153.90	—
1,050	1066.8	9.5	14.3	26.2	305.0	305.0	12.7	110.20	165.90	—
1,100	1117.6	9.5	14.3	26.2	343.0	305.0	12.7	125.00	178.40	—
1,150	1168.4	9.5	14.3	26.2	343.0	305.0	12.7	133.80	191.40	—
1,200	1219.2	9.5	14.3	26.2	343.0	305.0	12.7	142.90	204.80	—

FOR DIMENSIONAL TOLERANCES AND BEVEL DETAILS, SEE PAGE 49, 53.

* THE BACK-TO-FACE DIMENSION OF CAP SHALL BE E, IF THE BASIC WALL THICKNESS IS NOT MORE THE "LIMITED WALL THICKNESS" AND (THE BACK TO FACE DIMENSION OF CAP SHALL BE) E1, IF IT EXCEEDS "LIMITED WALL THICKNESS."